



Site Plan

- House 1
- Patio 2
- Approved/Future Pool 3
- Approved/Future Garage 4
- Open Lawn 5
- Driveway 6
- Road 7

North 

Development Plan



JPF CO
nantucket & real estate

**LUXURY
PORTFOLIO**
INTERNATIONAL™

THE **BLACKFISH** COLLECTION

Sconset
12 Blackfish Lane

\$2,825,000
4 Bedrooms | 4.5 Bathrooms

J Pepper Frazier Company
19 Centre Street
Nantucket, MA 02554
T 508.228.3202
www.jpfc.com



Photo: T.G. O'Leary

Design: workshop/apd



THE BLACKFISH COLLECTION

Welcome to The Blackfish Collection and the new start of rustic coastal living with a fresh, contemporary twist in Sconset. Intermingling historic integrity with stylish modern design, this 13-home community, named after the intelligent, long lived and extremely challenging-to-catch "blackfish," blends seamlessly into the fabric of Nantucket Island. A distinguished development team is transforming the pastoral setting of Sconset into a refined community where residents enjoy quiet spacious living, just a few minutes from the pounding surf of the beach. The Blackfish Collection is unique. It offers buyers a sophisticated approach to traditional Nantucket by combining open indoor and outdoor living spaces with innovative design, sustainable building materials and the highest quality construction, celebrating the property's unique island setting.

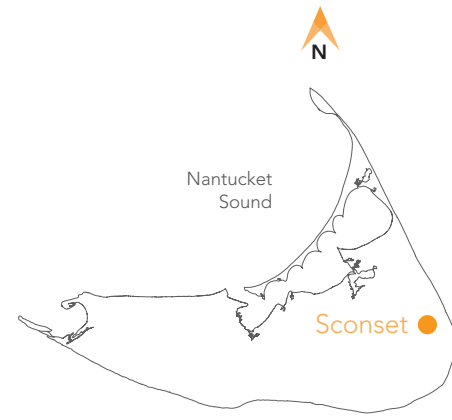

SCONSET epitomizes the nostalgic and natural beguilements that have made Nantucket as a whole an internationally treasured island. One of the most enchanting villages in the world, it lies inland on the eastern "elbow of sand," between the cranberry bogs and the rose-grown bluffs, where wild moors open to the endless sky and the ocean's sandy beach is just down the road. Today Sconset is a picturesque community that combines modest antique cottages with elegant new homes.

12 Blackfish Lane, Nantucket MA

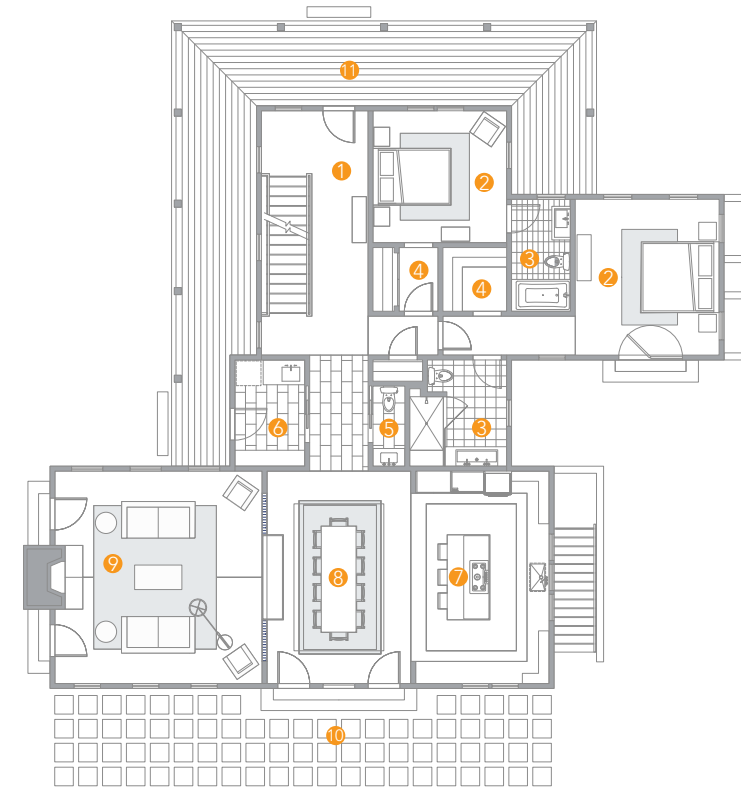

First Floor

- Entry 1
- Bedroom 2
- Bathroom 3
- Walk-in Closet 4
- Powder Room 5
- Mudroom 6
- Kitchen 7
- Dinning Room 8
- Living Room 9
- Patio 10
- Covered Porch 11

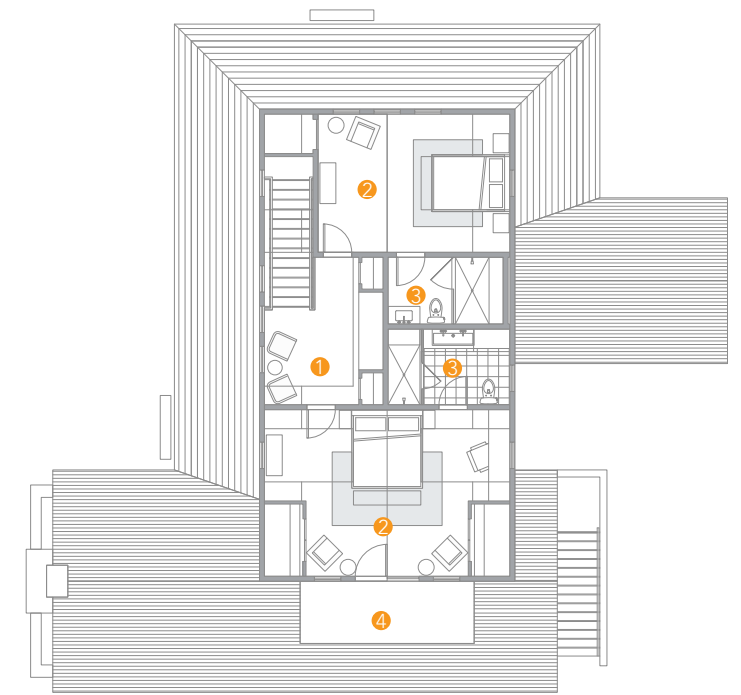

Second Floor

- Sitting Area 1
- Bedroom 2
- Bathroom 3
- Balcony 4

RESIDENCE

Incorporating the dramatic land and seascape views of Nantucket Island, **The Blackfish Collection** brings the outdoors in with sprawling open air spaces that give these new-built homes distinct character. Occupants find an abundance of natural light and the fluid transition between living spaces that make for spontaneous family gatherings.

EXTERIOR

The Blackfish Collection preserves the pastoral setting, emphasizing the relationship of the natural landscape and indigenous plant life. Seamlessly integrated, the designs feature natural cedar shingles with painted trim, mahogany decking, and outdoor spaces that capture the updated vernacular style while keeping with the close-knit feel of the Sconset community.

INTERIOR

Drawing inspiration from Sconset's seafaring tradition and indigenous landscape, The Blackfish Collection offers gracious informal living in unpretentious luxury. These distinctive designs deliver a refined "rusticism," with cathedral ceilings, natural woods, and organic textures.

Materials

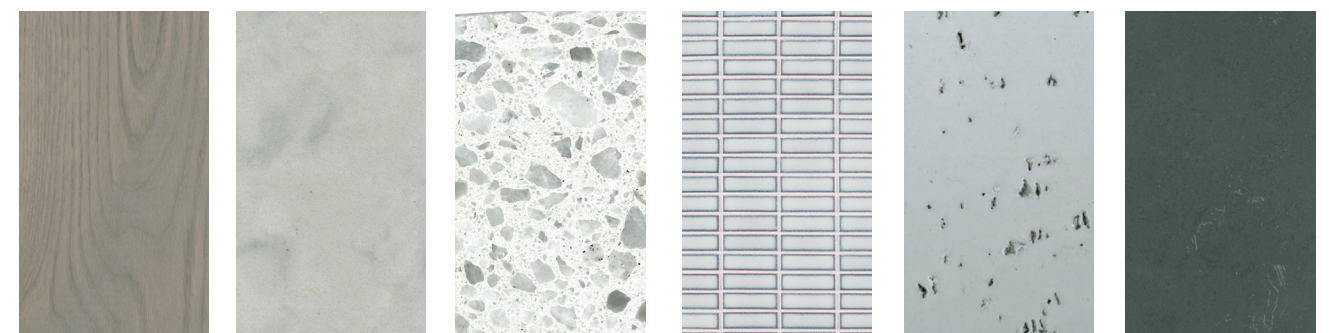

White Oak Misty Carrera Concrete - Saybrook Savoy Mosaic Gloss Brick - Gray Slate

\$ 2,825,000 U	Area	Sconset	Deck/Porch/Patio	Deck, Patio
	Year Built	Under Construction	Yard	Oversized
	Condition	New	Parking	Yes
	# Rooms	8	Heat	Heat/FHW
	# Bedrooms	4	DHW	Gas
	# Baths	4.5	Insulation	Yes
	Lot Size (sqft)	20058	Foundation	Poured Concrete
	Zoning	SR-2	Storms/Screens	Yes
	Water	Town	Lead Paint	No
	Sewer	Town	UFFI	No
	Map	73	Floors	White Oak
	Parcel	118	# Fireplaces	1
	View	Pastoral	Woodstove	No
Outdoor Shower	Yes		Stove	Bosch

The information contained herein is believed to be reliable but is not guaranteed.